

Born in Kolkata. Indian at Heart. Servicing the World.

Our Founder started on his dream journey in 1987. Modest Background and Humble beginnings have instilled upon us a never ending quest towards quality and customer service.

Our State of the Art Manufacturing facility is located in Domjur, NH6, Howrah, West Bengal with a total area of 1,00,000 SqFt (appx). We source our Raw Materials from USA, Middle East, China and India; we sell our products to over 250 Authorized Dealers in India and export to Neighbouring & SAARC countries.

We are rightly positioned to be a major national and international player in electrical components, wiring and panel accessories.

Our motto – Only the best is good enough – the HIRAWAT Group has emphasised the importance of high quality throughout the 23 years of operations. Having a strong and professionally sound group of employees and work force we are poised to be the country leader in the coming years. Our brand JIGO® is favoured by the industries and the dealers alike. All our products are of the best quality.

CABLE ACCESSORIES

- NYLON CABLE TIES
- STAINLESS STEEL TIES
- NYLON CABLE GLANDS
- METAL CABLE GLAND
- NYLON FLEXIBLE CONDUIT WITH IP 68
- BI-METALLIC LUGS
- CIRCLE CABLE NAIL CLIP
- INSULATED TERMINAL ENDS
- INDUSTRIAL PLUG
- INDUSTRIAL WALL SOCKET
- INDUSTRIAL STRAIGHT SOCKET
- INDUSTRIAL REV PLUG
- DISTRIBUTION BOX
- JUNCTION BOX
- HEAVY DUTY CONNECTORS
- METAL ROUND CONNECTOR
- CRIMPING TOOLS
- INDUSTRIAL CABLE DRUM WITH WIRE

AUTOMATION

- FLOAT SWITCH
- SWITCHING MODE POWER SUPPLY (SMPS)
- REVOLVING LIGHT
- TOWER LIGHT
- INDUSTRIAL BUZZER & SIREN
- AC PULLING SOLENOID
- TIMER AND HOUR RELAYS
- TEMPERATURE CONTROLLER
- GENERAL PURPOSE RELAY & SOCKET
- PROXIMITY SENSORS
- MICRO SWITCH
- LIMIT SWITCH
- FOOT SWITCH
- SOLID STATE RELAY

CONTROL & SWITCHGEAR

- FUSES
- JIGO RCCB
- AC/DC CONTACTOR
- ADD ON BLOCK TIMER
- SPARE COIL
- RELAYS
- ON/OFF ISOLATOR

PANEL ACCESSORIES

- PUSH BUTTONS
- MONOLEVER SWITCH/ JOY STICK
- INDICATOR LAMP
- PENDANT SWITCHES /CRANE SWITCHES
- ROCKER SWITCH
- CONTROL BOX

PANEL COOLING FAN

- ROUND COOLING FAN
- SQUARE COOLING FAN

Dealer's Stamp

www.jigoindia.com

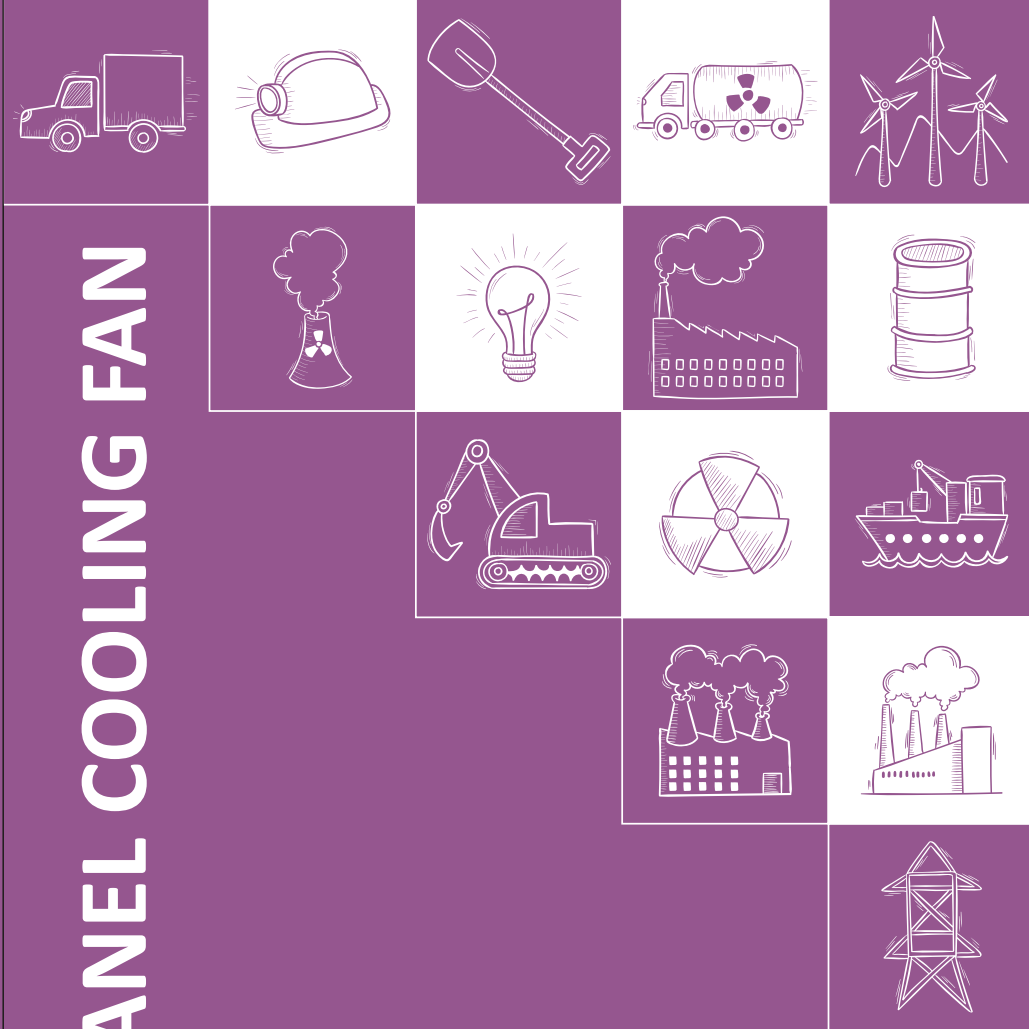

PANEL COOLING FAN

PANEL COOLING FANS

FEATURES

Each of the fans has flange protected motor for driving, a tubular frame and plastic PBT impeller. They have some superior features such as large air volume, small size, low power consumption, high efficiency and long life etc. They are specially used in Electrical Panels, Computer Systems, Office Automation products, Medical Instruments, Welding Machines and Automatic Appliances on the ground for air cooling and venting.

Technical Specification

Model	Voltage (V)	Current (A)	Power (W)	Air Volume (CFM)	Speed (RPM)	Noise Level (dB)
JG - DC-8025	12	0.18	2.16	38.60	3000	32.0
JG - DC-8025	24	0.08	1.92	38.60	3000	32.0
JG - AC-8025	110	0.13/0.11	12/11	15/18	2400/2500	28/28.5
JG - AC-8025	220	0.09/0.08	14/13	15/18	2350/2500	27/28
JG-DC-9025	12	0.20	2.40	50.00	3000	32.2
JG-DC-9025	24	0.12	2.88	45.00	2500	31.5
JG-AC-9025	220	0.08/0.07	16/15	28/34	2300/2500	27/26
JG - DC-12038	12	0.34	4.08	90	2500	36.5
JG - DC-12038	24	0.20	4.80	85	2300	35.0
JG - DC-12038	48	0.18	8.64	90	2500	36.5
JG - AC-12038	110	0.24/0.23	22/21	90/100	2600/3000	42/44
JG - AC-12038	220	0.14/0.13	22/21	90/100	2600/3000	42/44
JG - AC-12038BB	220	0.14/0.13	22/21	90/100	2600/3000	42/44
JG - DC-172150	24	0.65	15.60	160	2400	47.2
JG - AC-172150	110	0.47/0.46	37/35	150/170	2400/2800	47/47.5
JG - AC-172150	220	0.23/0.22	35/33	150/170	2400/2800	46/47
JG - AC-172150BB	220	0.23/0.22	35/33	150/170	2400/2800	46/47
JG - AC-172172	110	0.65/0.63	55/54	150	2200/2500	65
JG - AC-172172	220	0.30/0.29	55/54	150	2200/2500	65
JG - AC-172172BB	220	0.30/0.29	55/54	150	2200/2500	65
JG - AC-22060 R	220	0.31/0.30	56/54	180/178	2000/2050	41/42
JG - AC-22060 S	220	0.31/0.30	56/54	180/178	2000/2050	41/42



JG 8025

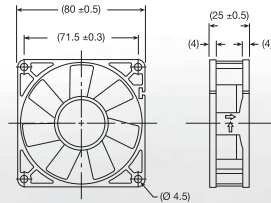

PANEL COOLING FANS



JG 9025

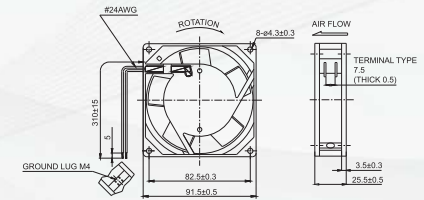

JG 12038

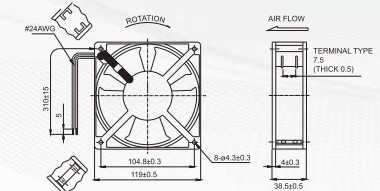

JG 172150

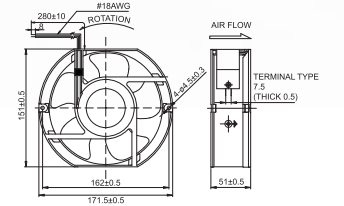

JG 172172

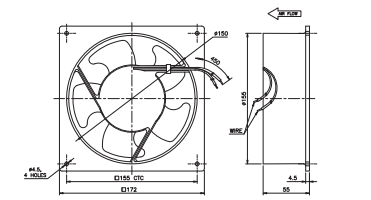

JG 22060

