

MICRO SWITCH

Basic Micro Switch

Operation speed	0.01mm-1m/sec
Operating frequency	Mechanical: 240 operations/min. Electrical: 20 operations/min.
Contact resistance	15mΩ max. (initial value)
Insulation resistance	100mΩ min. (at 500VDC)
Dielectric Strength	1000VAC, 50/60 Hz for 1 minute between terminals of the same polarity
	1500VAC, 50/60 HZ for 1 minute between current-carrying and non-current-carrying metal parts
	1500VAC, 50/60 HZ for 1 minute between each terminal and ground
Vibration	10-55Hz, 1.5mm double amplitude
Shock	Mechanical durable: 1,000m/Sec ² (about 100G'S) Malfunction: 300m/Sec ² (about 30G'S)
Ambient temperature	General purpose type: -25°C to +80°C (With no icing), Sealed type: -15°C to +80°C (With no icing)
Humidity	General purpose type: 85% RH max., Sealed type: 95% RH max.
Life	Mechanical: 20,000,000 operations/min. Electrical: 500,000 operations/min.
Weight	About 22 to 58g

Terminal Type

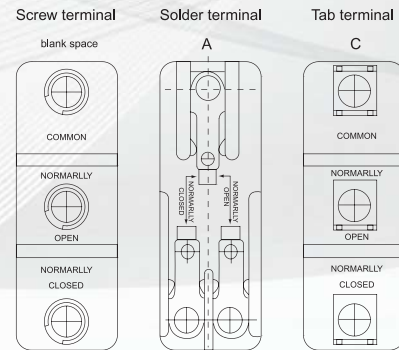

Models	JG - XZ-15G-B	JG - XZ-15GW-B	JG - XZ-15GW2-B	JG - XZ-15GW22-B
OF (Max.)	350g	70g	100g	160g
RF (Min.)	114g	14g	22g	42g
PT (Max.)	0.4mm	10mm	7.1mm	2.7mm
OT (Min.)	0.13mm	5.6mm	4mm	2.4mm
MD (Max.)	0.05mm	1.27mm	1.02mm	0.5mm
FP (Max.)		28.2mm	36.5mm	32.5mm
OP (mm)	15.9±0.4	19±0.8	30.2±0.8	30.2±0.4

JG - XZ-15G-B - Micro Switch Dot Point

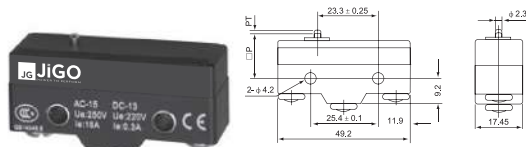

JG - XZ-15GW-B - Micro Switch Long Patti

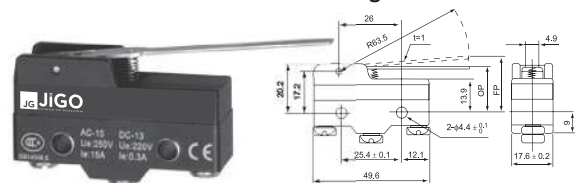

JG - XZ-15GW2-B - Micro Switch Long Patti Roller

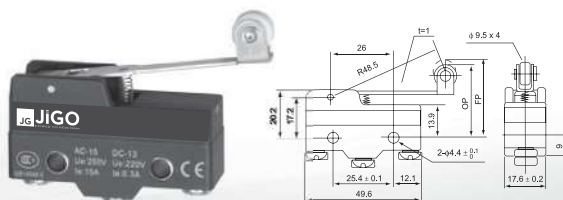

JG - XZ-15GW22-B - Micro Switch Patti Roller

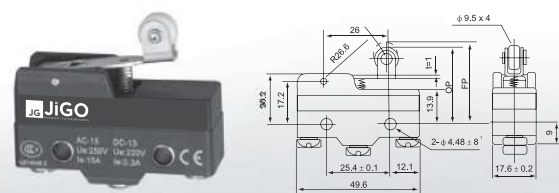

MICRO SWITCH

Basic Micro Switch

Model	JG - XZ-7100	JG - XZ-7310	JG - XZ-7120	JG - XZ-7311	JG - XZ-7140	JG - XZ-7141	JG - XZ-7121
OF (Max.)	600g	600g	180g	240g	220g	150g	600g
RF (Min.)	100g	100g	50g	80g	60g	40g	100g
PT (Max.)	2.0mm	2.0mm	11.0mm	6.5mm	8.5mm	13.5mm	2.0mm
OT (Min.)	0.8mm	6.0mm	3.0mm	2.0mm	2.5mm	4.0mm	6.0mm
MD (Max.)	0.8mm	0.8mm	2.4mm	1.5mm	2.0mm	3.2mm	0.8mm
OP	30.5±0.8mm	21.8±1.2mm	40±1mm	40±1mm	25±1mm	25±1mm	33.3±1.2mm
FP				46mm	32mm	35mm	

JG - XZ-7100 - Micro Switch Short Push Plunger

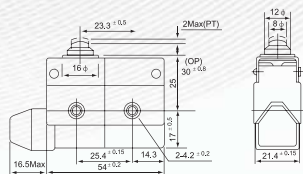

JG - XZ-7310 - Micro Switch Panel Mount Plunger

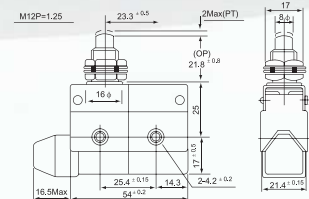

JG - XZ-7121 - Micro Switch Long Hinge Roller Lever

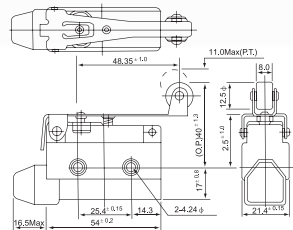

JG - XZ-7141 - Micro Switch Short Hinge Roller Lever

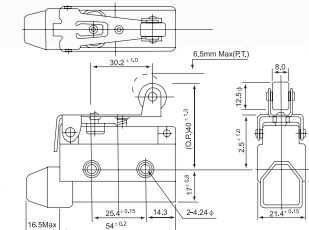

JG - XZ-7140 - Micro Switch Short Hinge Lever

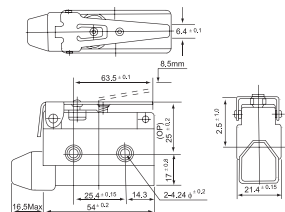

JG - XZ-7120 - Micro Switch Long Hinge Lever

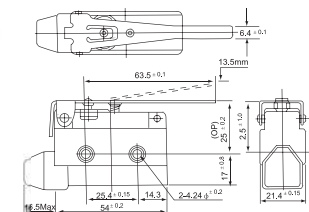

JG - XZ-7311 - Micro Switch Parallel Roller Plunger

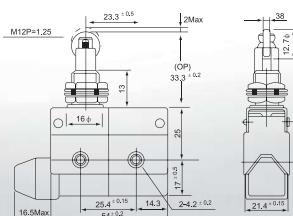

MICRO SWITCH

Basic Micro Switch

Model	JG - XV-15-1C25	JG - XV-151-1C25	JG - XV-152-1C25	JG - XV-153-1C25	JG - XV-155-1C25	JG - XV-156-1C25
OF (Max.)	2.4N	2.4N	1.23N	0.69N	2.7N	1.23N
RF (Min.)	0.49N	0.49N	0.14N	0.06N	0.49N	0.14N
PT (Max.)	1.2mm	1.6mm	4.0mm	9.0mm	1.5mm	4.0mm
OT (Min.)	1.0mm	0.8mm	1.6mm	2.0mm	0.8mm	1.6mm
MD (Max.)	0.4mm	0.6mm	1.5mm	2.8mm	0.6mm	1.5mm
OP (mm)	14.7±0.4mm	15.2±0.5mm	15.2±1.2mm	15.2±3mm	20.7±0.6mm	20.7±1.2mm

Model	JG - XV-15-1B5	JG - XSS-5	JG - XSS-5GL	JG - XSS-5GL2	JG - DS-438
OF (Max.)	200g(1.96N)	160g(1.57N)	70g(0.7N)	90g(0.9N)	200g(1.96N)
RF (Min.)	50g(0.49N)	25g(0.25N)	10g(0.1N)	14g(0.14N)	50g(0.49N)
PT (Max.)	1.2mm	0.6mm	2.2mm	1.6mm	1.2mm
OT (Min.)	0.6mm	0.5mm	0.5mm	0.8mm	0.6mm
MD (Max.)	0.3mm	0.3mm	0.5mm	0.5mm	0.5mm
OP (mm)	14.7±0.5mm	8.4±0.5mm	8.8±0.6mm	15.2±0.5mm	21.3±0.4mm

JG - XV-15-1C25 - Micro Switch Basic Point (NO+NC)

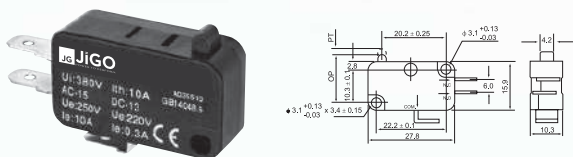

JG - XV-151-1C25 - Micro Switch Basic Patti (NO+NC)

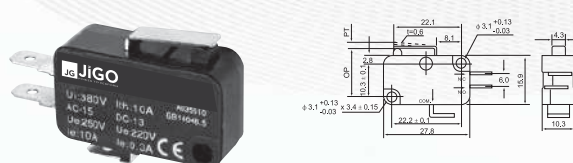

JG - XV-152-1C25 - Micro Switch Basic Small Patti (NO+NC)

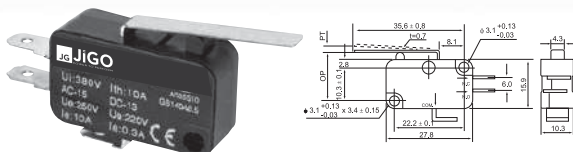

JG - XV-153-1C25 - Micro Switch Basic Long Patti (NO+NC)

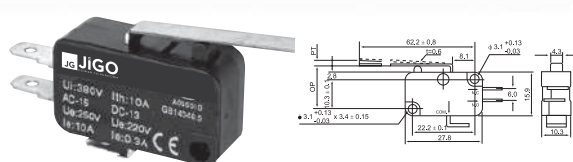

JG - XV-155-1C25 - Micro Switch Basic Patti Roller (NO+NC)

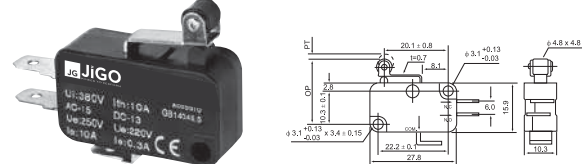

JG - XV-156-1C25 - Micro Switch Basic Long Patti Roller (NO+NC)

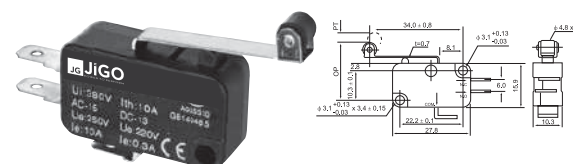

JG - DS-438 - Micro Switch Basic Electronic Push Button RED

